

ROOF LEVEL FLOOR PLAN

Exclusive, versatile and completely unique, the St. Cloud rooftop offers the ultimate New York City meeting space for hosting all manner of corporate and social events. Crowning The Knickerbocker's renowned Times Square location, the indulgent bar and lounge space is enviably perched directly beneath the iconic New Year's Eve Ball with privileged views of the most visited place on earth.

1. Club Room
2. Waterford Lounge
3. St. Cloud Bar & Perimeter Seating
4. 42nd Street Pod
5. Southwest Pod
6. Times Square Pod
7. Northwest Pod
8. Northeast Pod
9. Club Macanudo at The Knick

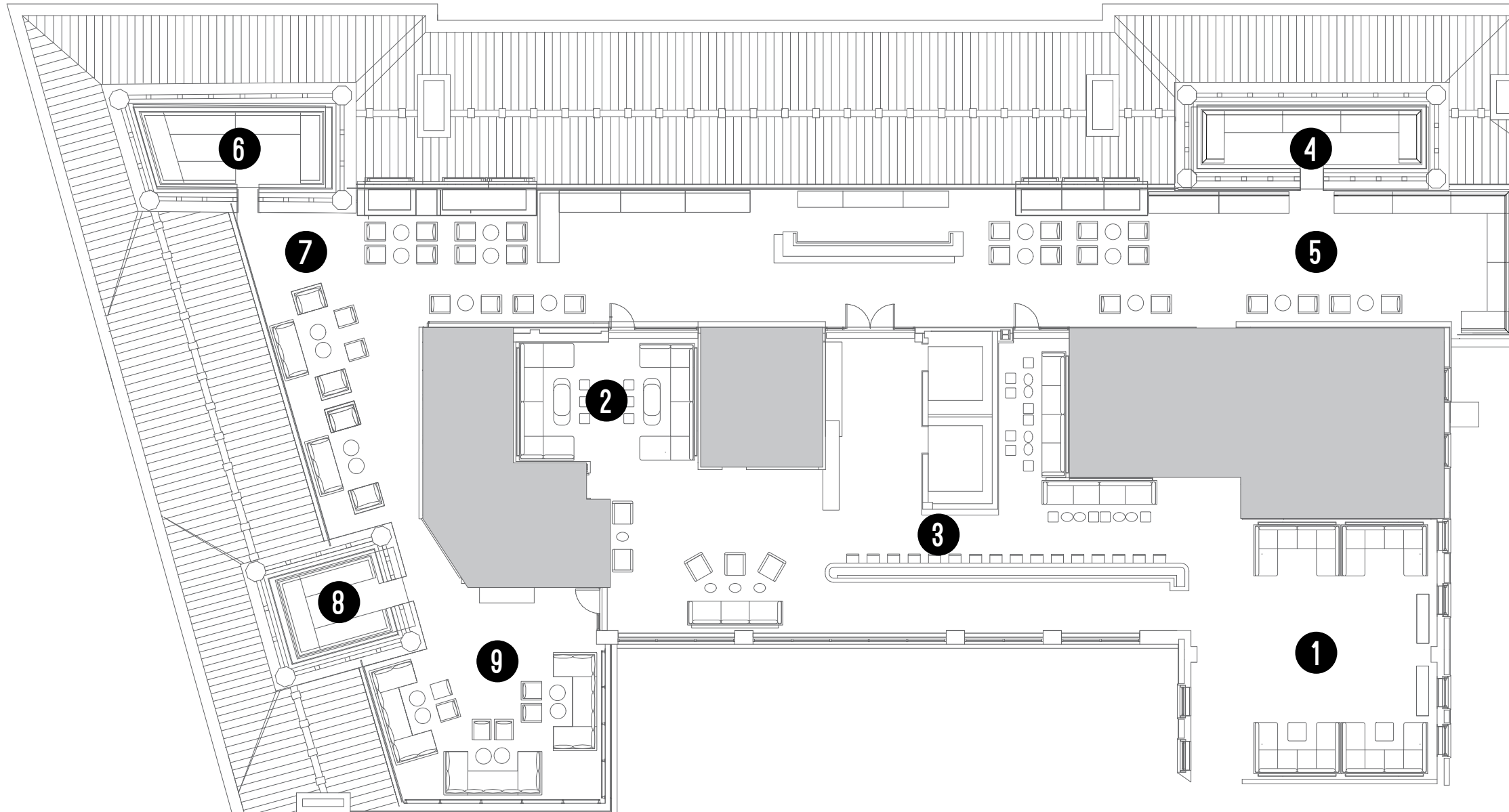

	Length	Width	Ceiling Height	Sq. Ft.	Existing Capacity	Reception	Banquet	Theater	Classroom	U-Shape
FOURTH LEVEL										
The Salon	41	54	9	2,200	-	160	100	150	60	36
Salon Foyer	-	-	9	450	-	40	-	-	-	-
Charlie Palmer Bar & Lounge										
Library Foyer	-	-		1,200	30	60				
The Library	-	-	-	-	36	40				
Charlie Palmer Main Dining Room	-	-	10	1,600	90	125				
ROOFTOP										
Total Rooftop	-	-	N/A	7,800	250	250	-	-	-	-
Club Room	-	-	9	800	60	60	-	-	-	-
Waterford Lounge	-	-	9	840	50	30	-	-	-	-
St. Cloud Bar & Perimeter Seating	-	-	9	1,000	60	60	-	-	-	-
42nd Street Pod	-	-	Outdoor	200	18	25	-	-	-	-
Southwest Pod	-	-	Outdoor	1,500	80	80	-	-	-	-
Times Square Pod	-	-	Outdoor	240	20	20	-	-	-	-
Northwest Pod	-	-	Outdoor	1,000	75	75	-	-	-	-
Northeast Pod	-	-	Outdoor	140	12	12	-	-	-	-
Club Macanudo at The Knick	-	-	Outdoor	500	35	35	-	-	-	-

CAPACITY CHART

To learn more about planning an event at The Knickerbocker, please contact the sales team at 212.204.5793 or sales@theknickerbocker.com.